



26 Blakenham Road, London, SW17 8PA

Good Move are delighted to offer this two bedroom mid-terrace home situated on Blakenham Road.

This spacious two-bedroom home offers well-proportioned accommodation arranged over two floors. The ground floor features a welcoming entrance hall, a generous lounge providing ample space for both relaxing and entertaining, and a fitted kitchen with access to a useful conservatory overlooking the rear garden.

Upstairs, the property offers two good-sized bedrooms and a family bathroom. Externally, the home benefits from a private rear garden, providing an ideal space to enjoy the warmer months. A useful garden shed offers additional storage.

Combining comfortable living space with a private outdoor setting, this property presents a fantastic opportunity for purchasers seeking a home with plenty of potential in a convenient residential location.

Blakenham Road is located in the heart of Tooting and equidistance between both Tooting Bec and Tooting Broadway Underground Station (Northern line, zone 3) with services to the City and West End. Both Tooting Bec and Tooting Broadway boast a wonderful selection of boutique shops, supermarkets, cafes, and pubs and Tooting Bec Common is also just a short stroll away.

The property has been attractively priced and we invite all buyers in a position to proceed to view.

Please call for more information.



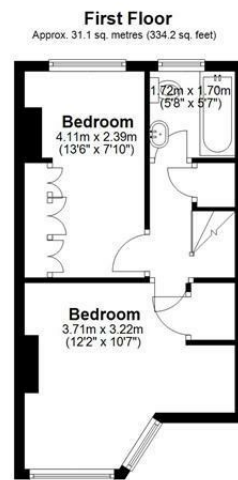
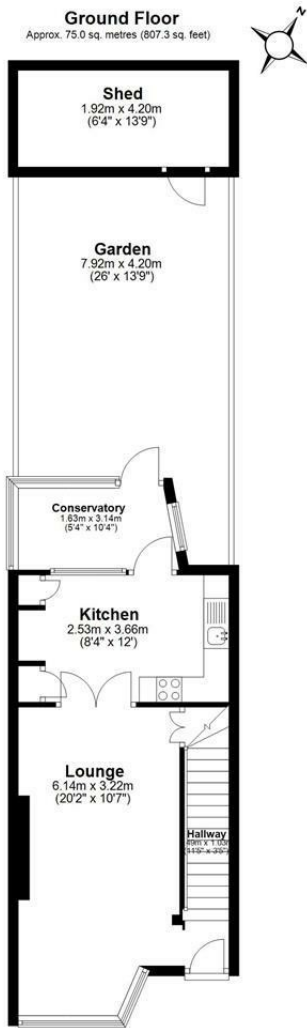

Total area: approx. 106.1 sq. metres (1141.6 sq. feet)

This floor plan has been created by a third party and should be used as a general outline for guidance only. Any areas, measurements or distances quoted are approximate and any intending purchaser or lessee should satisfy themselves by inspection, searches, enquiries and/or full survey as to the correctness of each statement. We accept no responsibility or liability for any loss whatsoever that may arise as a result of this plan and the information contained within.

© @modephotouk | www.modephoto.co.uk
Plan produced using PlanUp. □

Bleckenham Road

